

Portable EV Charger

User Manual

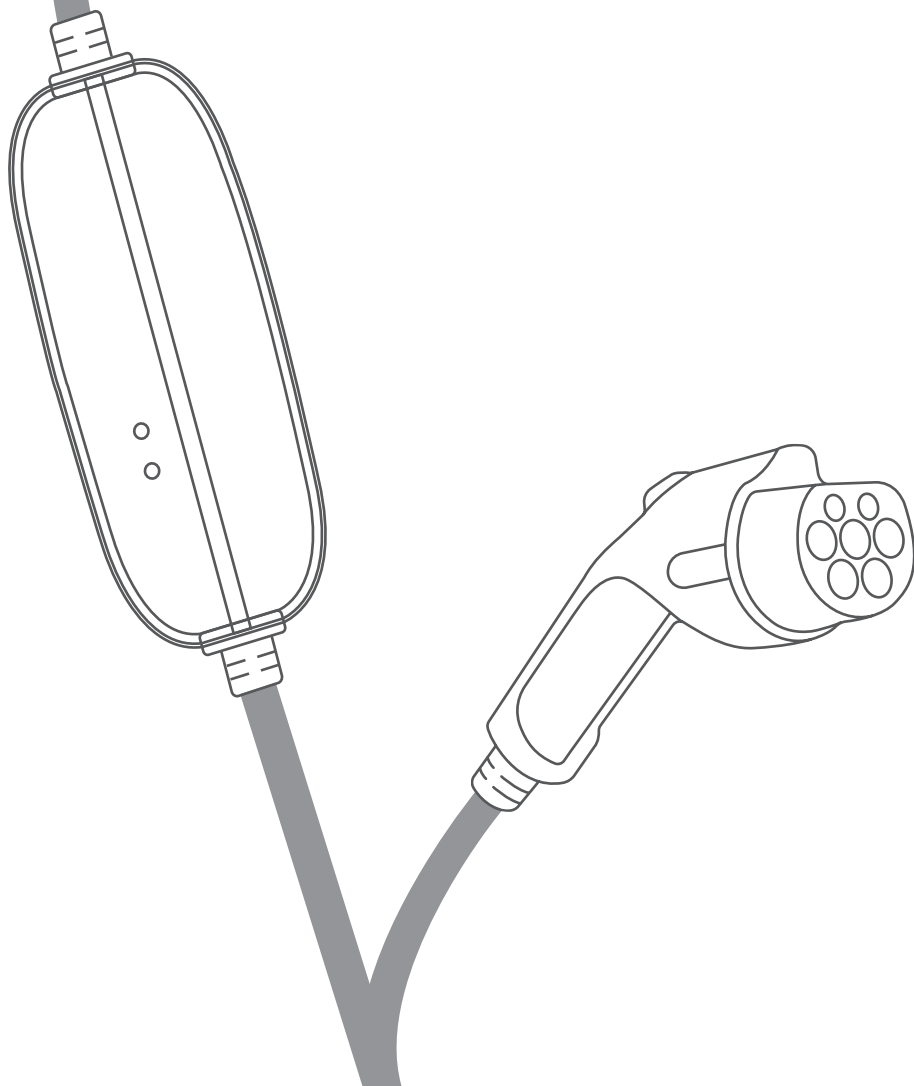

Please Read All Instructions Carefully before Using

Safety Information

For your own safety and the safety of others, and to prevent damage to the device and vehicles upon which it is used, it is important that the safety instructions presented throughout this manual be read and understood by all persons operating or coming into contact with the device.

- 1) "IMPORTANT SAFETY INSTRUCTIONS" AND "SAVE THESE INSTRUCTIONS"
- INSTRUCTIONS MPORTANTES CONCERNANT LA SECURITE CONSERVER CES INSTRUCTIONS.
- 2) INSTRUCTIONS PERTAINING TO A RISK OF FIRE OR ELECTRIC SHOCK
- INSTRUCTIONS AYANT TRAIT A UN RISQUE D'INCENDIE OU DE CHOC ELECTRIQUE.



DANGER

Indicates an imminently hazardous situation which, if not avoided, will result in death or serious injury to the operator or bystanders.



WARNING

Indicates a potentially hazardous situation which, if not avoided, could result in death or serious injury to the operator or bystanders.

Important Safety Instructions

Read all the instructions before using this product.

- 1) This is a EV charger for EVs with GB/T inlets. Don't use it for EVs with different inlet types.
- 2) This cable has a precise internal structure. Any questions, please contact our Customer Service at the first time. Please don't take it apart without any professional technical support.
- 3) The product is only for EV charging. Please don't use it in any other occasions, including hauling, binding and so on.
- 4) Don't use it in water.
- 5) This device should be supervised when used around children.
- 6) Do not put fingers into the electric vehicle connector.
- 7) Do not use this product if the flexible power cord or EV cable is frayed, has broken insulation, or any other signs of damage.
- 8) Do not use this product if the enclosure or the EV connector is broken, cracked, open, or shows any other indication of damage.
- 9) The device must be grounded.
- 10) Do not use this device with an extension cord or an adapter.
- 11) Mind the risk of electrical shock or burn.
- 12) The device does not contain any user-serviceable parts.
- 13) Please do not disconnect the plugs while the EV charger is charging the vehicle.
- 14) Handle the equipment with care during transportation. Do not subject it to strong force or impact or pull, twist, tangle, drag or step on the equipment, to prevent damage to it or any components.



Lightning Protection Measures

- 1) The EV charger should not be exposed to lightning-prone environments, especially during thunderstorms.
- 2) Do not use the charging gun for charging when thunderstorms are approaching or are predicted. Disconnect the charging gun from the power source immediately.



Lightning Protection Measures

- 1) When using the EV charger, follow the following safety guidelines to prevent fire accidents:
 - Do not use or store the charging gun near flammable materials.
 - Ensure the surrounding environment is dry, clean, and free from ignition sources and flammable substances.
 - Regularly inspect the integrity and reliability of the charging equipment and connecting cables to avoid the risk of fire due to damage.
- 2) If any signs of electric leakage, smoke, or other fire hazards are noticed with the charging gun, immediately cease using it and inform professional technicians for inspection and repair.

Content

Product Overview ----- 1

Operating Instructions ----- 2

Parameters ----- 3

Display Values And Led Indicators ----- 4

Save these Instructions ----- 5

Product Overview

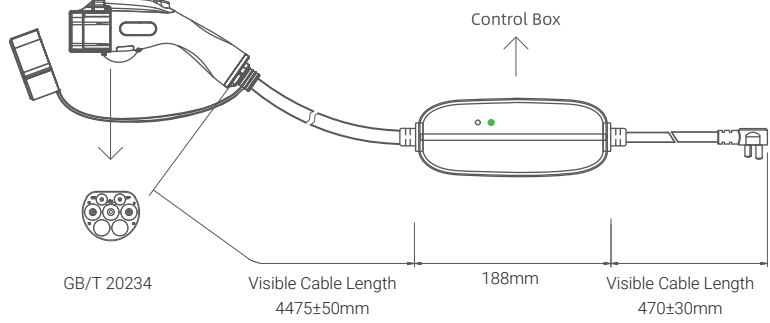

Operation Conditions

Operation is subject to the following the conditions:

- (1) This device may not cause harmful interference.
- (2) This device must accept any interference received, including interference that may cause undesired operation.

Operating Instructions

Please complete the settings before charging. Do not set up during charging, otherwise the charger will be damaged!

Start Charging

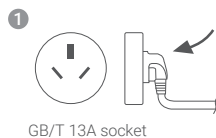

Firmly insert the power plug into the outlet on the wall.

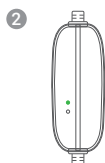

Ready for charging:
The green LED lights on
brightness steady.

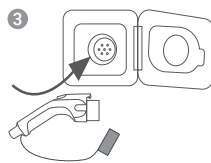

Insert the charging plug into
the car charging port.



Start charging:
The LED keeps
blinking slowly
and regularly

Stop Charging

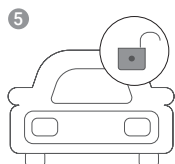

Unlock the car and stop
charging process via the
screen or App of the car
(refer to the instruction of
your car).

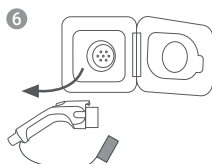

Remove the charging plug
from the car charging port.

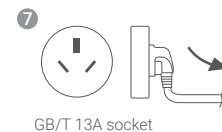

Remove the power plug
from the wall outlet.

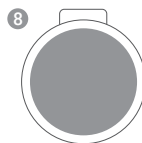

Put the charger into
the storage bag.

Use Tips

- Make sure to use considerable force when plugging in the charger until the pins are well connected to the socket on the car.
- If the neutral wire of the wall socket is wrongly connected, the charger might not work.
- The car needs to be unlocked and powered off to start the charging process.
- The car plug must be plugged directly into a Type 1 socket.

Parameters

Charging Standard for EV	GB/T 20234.1
Model (Design Model)	WB-GP2-AC1.2-13AS-A1
Nominal Voltage	220V AC
Gird Frequency	50/60Hz
Nominal Current	13A
Applicable Plug	GB/T 16A plug (GB/T 2099.1)
Enclosure Type	IP 66 (enclosurer)
Length	5m
Working Temperature	-30°C to +50°C
Storage Temperature	-40°C to +80°C
Charging Protection	Current-leakage Protection, Over-heat Protection, Lightning Protection, Over-current Protection, Under-current Protection, Over-voltage Protection, Under-voltage Protection, Grounding Detection, Automatic Power-off

Display Values

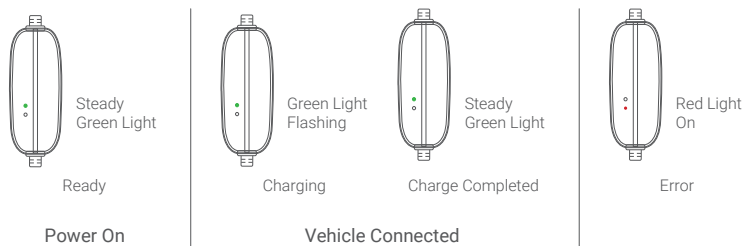

Light Indicator

Power-on	Charger energized	Green in LOW brightness
Standing-by	Energized but charging plug is not connected to the vehicle	Green in LOW brightness
Vehicle Connected	The charging plug is plugged in port on the vehicle	Green in HIGH brightness
In Charging	In normal charging process	Green, Breathing
Charging Paused	Charing paused on the vehicle side request, the charger output turns off	Green, Blinking
Non-fault Shutdown	Non-fault shutdown and charging plug keep connected	GREEN in HIGH brightness
Failure	Faults detected, charger output shutdown	RED (see Fault Codes)

Fault Codes

Red Light Codes	Fault Status
1 flash followed by 1.5 seconds pause	Charging Plug Connection Error
2 flashes followed by 1.5 seconds pause	Overvoltage
3 flashes followed by 1.5 seconds pause	Overcurrent
4 flashes followed by 1.5 seconds pause	Undervoltage
5 flashes followed by 1.5 seconds pause	Undercurrent
6 flashes followed by 1.5 seconds pause	Output Contactor Failure
7 flashes followed by 1.5 seconds pause	PCB Overtemperature
8 flashes followed by 1.5 seconds pause	Leakage Current Detected
Steady Red light	Ground Fault
10 flashes followed by 1.5 seconds pause	RCD Self-test Failure
11 flashes followed by 1.5 seconds pause	Metering communication failure

Save these Instructions

Moving and Storage Instruction

1. Do not pull the cable by hand when removing it from the wall and installing it.
2. EV charger must be stored in a clean, ventilated and non-corrosive indoor environment. Ambient temperature and humidity values will directly affect and quality of EV Charger. Temperature and relative humidity must meet the following requirements:

Storage temperature: -40°C to +80°C

Storage humidity: 5%-95%

User Maintenance Instructions

1. Clean the appearance and charging interface of the charging station regularly using a clean damp cloth. Do not use any corrosive substances to clean.
2. Check the cables and plugs of the charging station for any damages. If found, please repair or replace them promptly.
3. Regularly inspect the power cord and connectors of the charging station to ensure they are securely fastened.
4. If any abnormal conditions are observed, such as excessive heat, strange odor, or damages, immediately stop using the charging station and connect the after-sales service for assistance.

Two Years Limited Warranty

The warranty gives you specific rights and you may also have other rights, which vary in different states and countries. Our company warrants to the original consumer purchaser that this product is free of defects in materials and workmanship for 2 years from the purchase date. This warranty does not cover labor for removal or reinstallation of the product and is void on any product installed improperly or in an improper environment, overloaded, misused, opened, abused, or altered in any manner. Our company excludes incidental or consequential damages for breach of any warranty on this product. Some jurisdictions may not allow limitations on how long an implied warranty lasts or the exclusion or limitation of incidental or consequential damages, so the above exclusions or limitations may not apply to you.